

# FUTURE VILLAGE



## Placemaking Services

*turning spaces into places*

# Placemaking

In all towns and cities there are areas of poor public design. These areas may be lacking in greenery, be stressed due to urban heat island effect, lack public seating or have no components to attract the local community to dwell, shop local, exercise or just appreciate the outdoors. Placemaking is the discipline of changing an area to overcome these elements.

Placemaking covers a broad spectrum of skills. At Future Village we concentrate on the visualisation, delivery and maintenance of places. We understand how to help you take your findings and then convert them into a physical asset that your community desires.

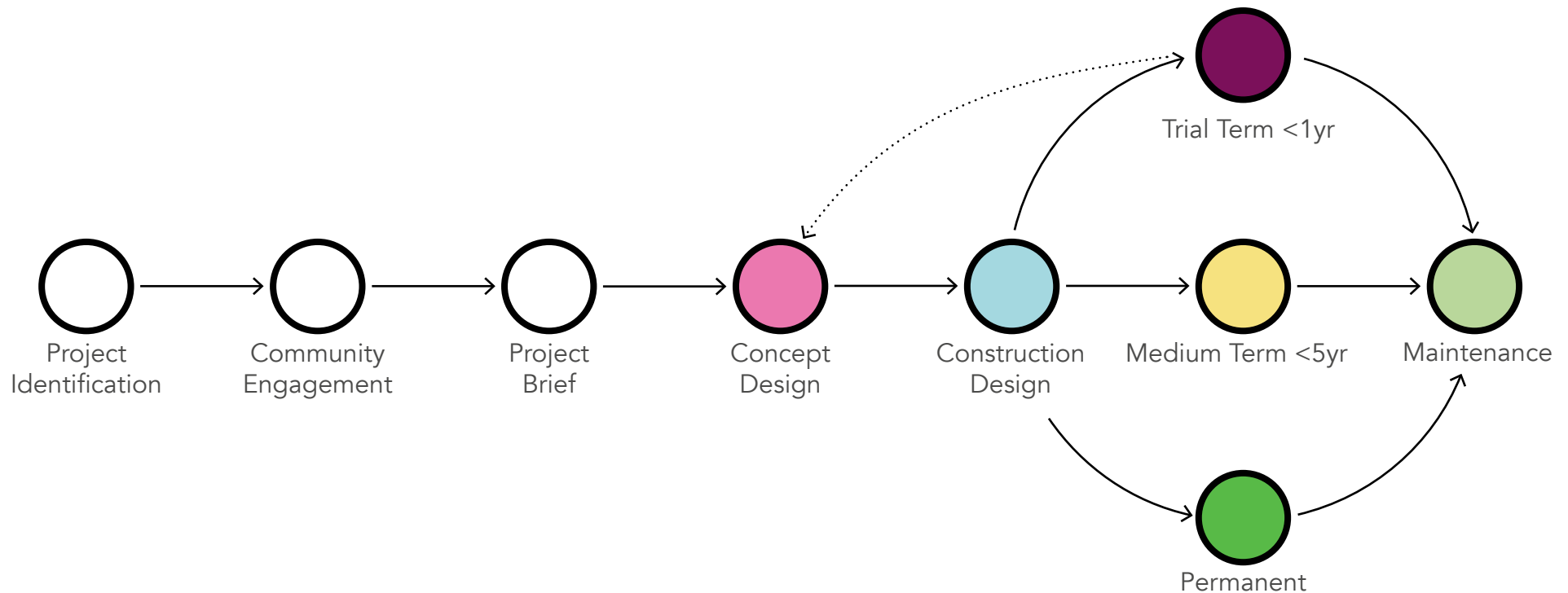

# Concept Development

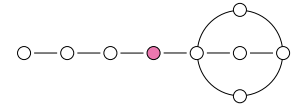

Concept design combines creative thinking and an understanding of construction methodology to interpret the project brief. Our interdisciplinary design team works with our clients to refine the concepts into a realistic concept design.

From experience we've found that 3D imagery and fly throughs provide all stakeholders with a greater understanding of the proposed build. For our clients going back into community and stakeholder workshops these visualisations are easier to interpret and gain more relevant feedback than technical drawings.



# Construction Design

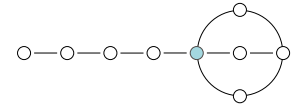

The signed off Concept Design moves into the construction design phase. Our technical drawings enable all factors of the project to be delivered. They also outline any potential issues before build from survey work and consultation with different trades.

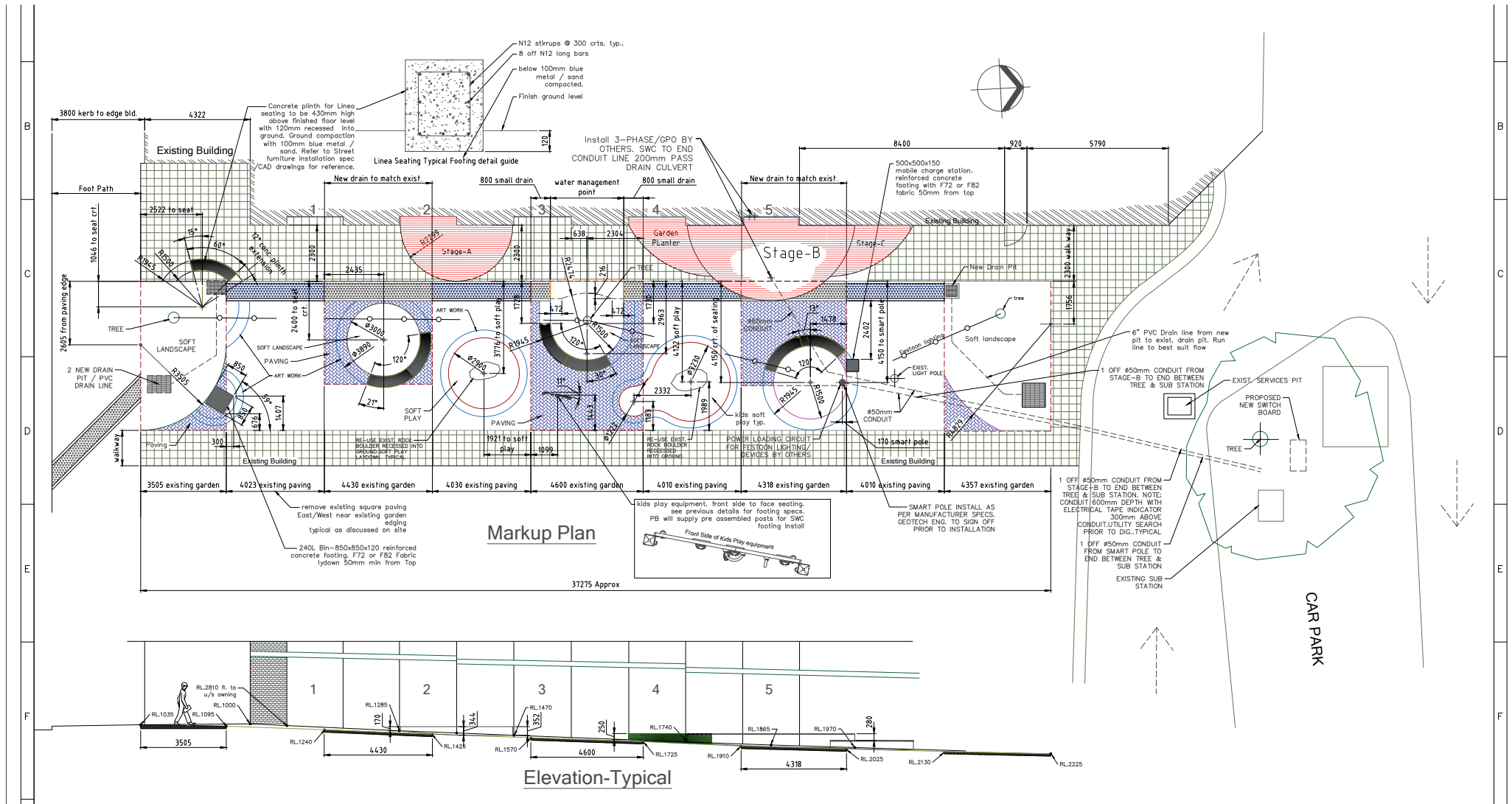

# Trial Places - <1yr

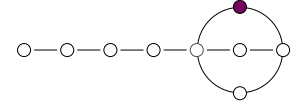

There are many streets and public spaces within our urban areas that are more suited to becoming a piazza or town square than a traffic thoroughfare. Getting buy in from locals to close a road can be challenging.

Offering to undertake a short term trial is an easier way to win over support. This gives the public a chance to experience the benefits over a short term to validate a permanent closure.

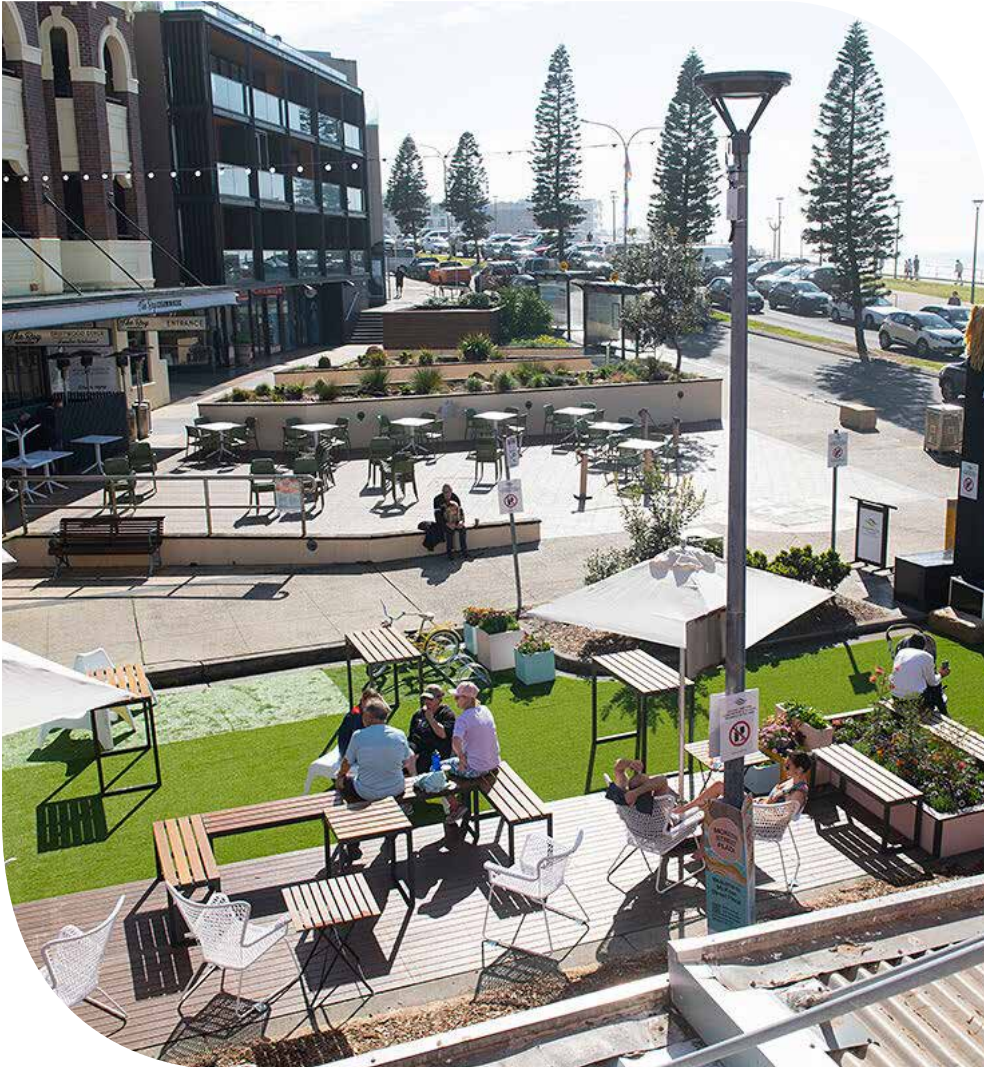

# Trial Places - Events

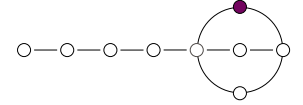

We hold a wide variety of our modular green infrastructure with mature plants at our depot that we use for rental or event hire. These bring greenery, cooling, colour to help create natural zones within your event space.

We also provide seating, decking and shade structures. Hiring can be done for short or longer term events.



# Medium Term Places

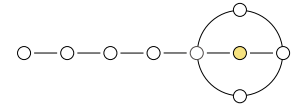

The expense of civil works or public-space, road-closure time can be prohibitive for placemaking, however sometimes areas need immediate change.

These limitations are overcome by designing places with free standing green infrastructure that can be installed in a fast time frame. We design using our modular system or deliver bespoke medium term builds.



# Permanent Places

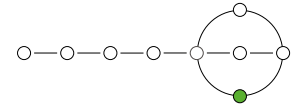

Permanent placemaking is the conversion of public space (roads, plazas, parks) into new places. We have lead project management capability for all civil works. We have partner contractors that cover

civil, electrical, storm water, soft fall, playground equipment, ground painting, surveying, lighting, audio, solar and engineering services.





# Maintenance Services

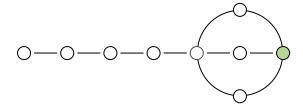

The long term success of placemaking can be directly related to how well a place is maintained. We have our own maintenance teams in Sydney and Melbourne. With our wicking and water reservoirs found

in all our green infrastructure to reduce watering requirements and materials chosen for their durability we design to reduce overall maintenance requirements.





## Contact us for ideas and concepts

Future Village offers design, manufacturing, installation, project management and maintenance services.

Ben Perry  
Design and Placemaking Director  
ben@futurevillage.com.au  
0425 324 256

Peter Casimaty  
Managing Director  
peter@futurevillage.com.au  
0406 072 229

*'In the spirit of reconciliation the Future Village acknowledges the Traditional Custodians of country throughout Australia and their connections to land, sea and community. We pay our respect to their Elders past and present and extend that respect to all Aboriginal and Torres Strait Islander peoples today.'*